

mixed friction range  5 bar — 6 bar —

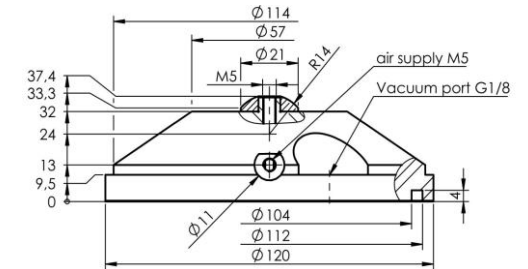

Thermodynamically optimized air cushion due to micro groove system.<sup>1)</sup> Bearing surface with dry running coating. Clean room bearing with additional air-extraction system.

Air supply pressure <sup>2)</sup>	bar <sub>rel</sub>	5	6
Maximum carrying capacity	N	3100	3700
Nominal carrying capacity	N	1800	2050
Gap height <sup>3)</sup>	μm	11.6	11.6
Static stiffness <sup>3)</sup>	N/μm	170	195
Air consumption <sup>3)</sup>	l/min	6.7	8.3
Maximum velocity <sup>3)</sup>	m/s	5	6
Weight	g	710	710

Air supply thread	M5
Adapted with pressure screw	EZ-0249 M24x1.5-R14

<sup>1)</sup> Patents: US 6,164,827, DE 199 18 564 A1

<sup>2)</sup> deviating supply pressures on request

<sup>3)</sup> at nominal carrying capacity

Visit our website for information on bearing design and function, counterface and air quality requirements, and the definition of gap height.

Subject to technical modifications and typographical errors.